

PHILIPS

Sensors

EasyAir

office sensor advanced
grouping SNS200



Quick Installation Guide

EasyAir office sensor advanced grouping SNS200

Ordering data

Commercial product name	Color	Description	EOC	12NC	Carton Quantity
EasyAir SNS200/w	White	Office Sensor Advanced Grouping	8718696 698945 00	929000 766 803	50 pcs
EasyAir SNS200/g	Grey	Office Sensor Advanced Grouping	8718696 712412 00	929001 560 703	50 pcs

Compatible LED Drivers

Logistic code 12NC	Description
929001516306	Xitanium 36W 0.3-1A 54V SR 230V
929001505006	Xitanium 75W 0.7-2.0A 54V SR 230V
929001540406	Xitanium 35W 0.08-0.35A 150 V SR 230V
929001540506	Xitanium 60W 0.08-0.35A 220 V SR 230V
929001540606	Xitanium 60W 0.08-0.35A 300 V SR 230V
929001540706	Xitanium 100W 0.25-0.7A 220 V SR 230V
929001540806	Xitanium 100W 0.15-0.5A 300 V SR 230V iXt
929001540906	Xitanium 100W 0.2-0.7A 300 V SR 230V iXt

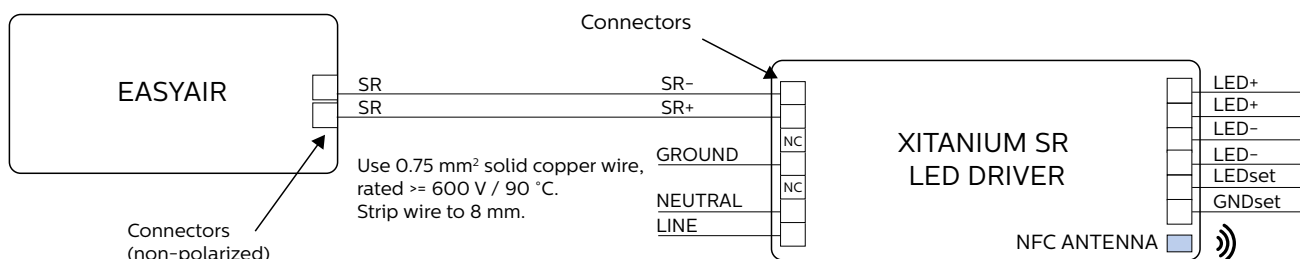

January 2018

¹ View limited warranty at: http://images.philips.com/is/content/PhilipsConsumer/PDFDownloads/Global/ODLI20150105_001-UPD-en_GB-152795-PHI-component_warranty-HR.PDF

EasyAir office sensor

Sensor Dimensions (mm)

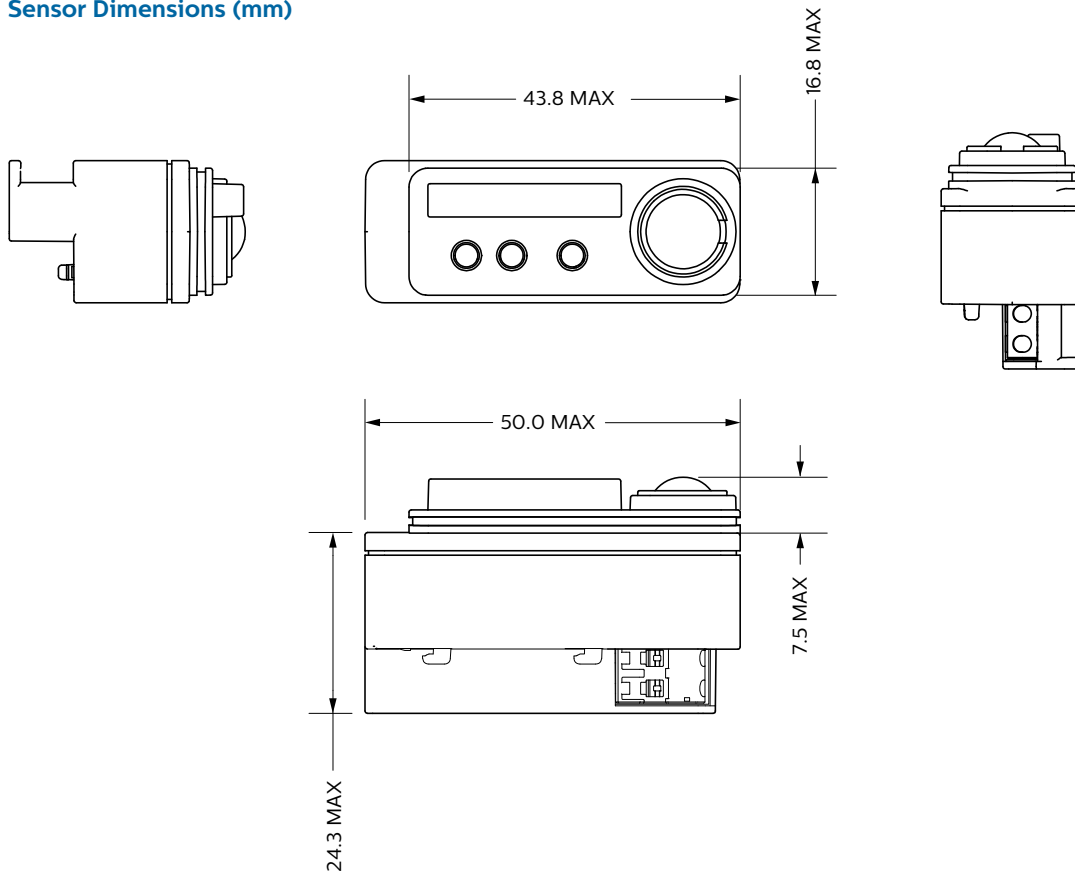

Mounting Dimensions (mm)

Mounting in U-shaped slot in sheet metal (max thickness 1 mm)

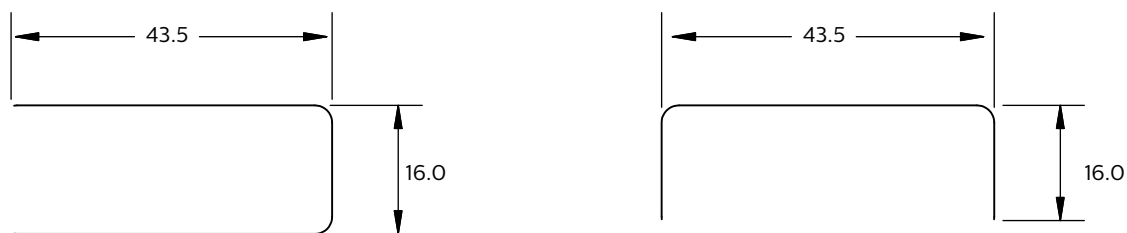

Mounting in cut-out in sheet metal (thickness 0.7 mm to 1.2 mm)

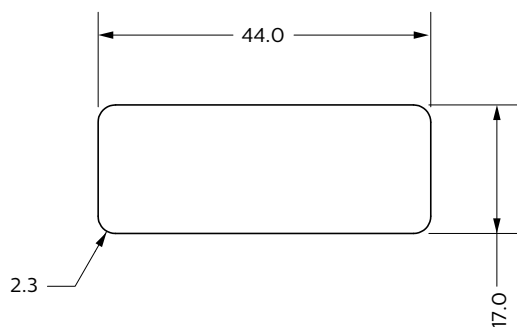

Luminaire with EasyAir installed

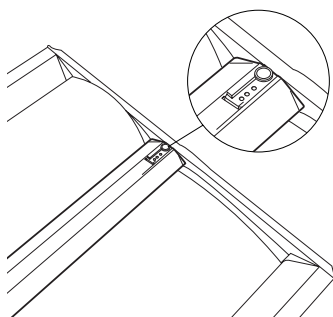

Mounting in a slot

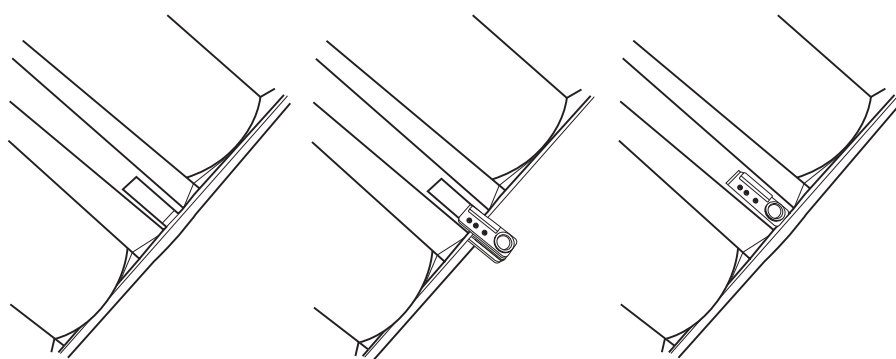

Mounting in SMB-50 bracket

All dimensions in mm.

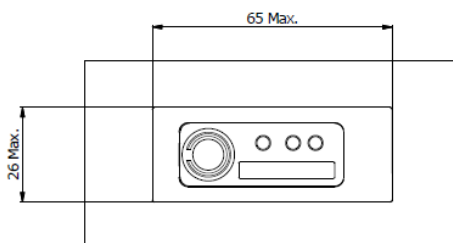
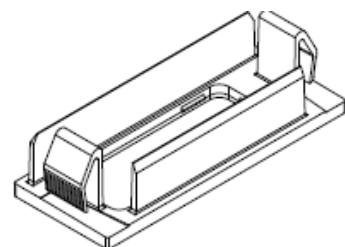

Installing EasyAir office sensor with ceiling mount bracket (SNS200CMP)

The ceiling mount bracket SNS200CMP is premounted with EasyAir SNS200 sensor and the cable. See the cut-out in ceiling and mounting dimensions below, all in mm.

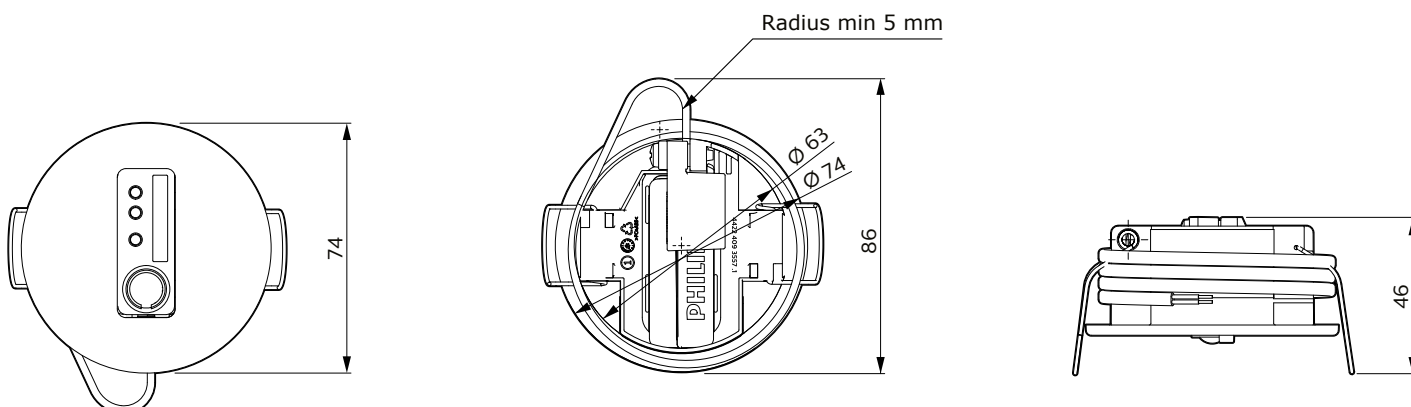

Product Data

Electrical Information

Input Voltage	Powered by SR driver low-voltage interface
Current Consumption	13 mA
Nominal Power Consumption	200 mW
Standby Power	< 1 W on luminaire level, including driver standby power

Occupancy Sensing

Type	Passive infrared (PIR)
Occupancy based control	Default enabled
Occupancy Mode	Auto-on/off, Manual-on/off, Manual-on/auto-off; Red LED indicates "on"
Group Occupancy Sharing	Enabled/disabled
Group Light Behaviour	Background Light Level, Field Task Level
Hold Time	0.5 - 60 minutes
Viewing Angle	X = 72°, Y = 86° (See detection pattern)
Background Light Level	0-100%
Prolong Time	0 minutes - infinity
Grace Fading	0-25 sec
Response Time/Fading to Switch On/Off	0.7 sec

Daylight Sensing

Daylight based control	Default enabled
Auto-calibration	Upon power-up
Daylight dependent switching	Default disabled
Daylight dependent override	Default disabled
Viewing Angle	40° (half value sensitivity); 2% cut-off point at 75°

Task Tuning

Full Light Setting	0-100%
--------------------	--------

Environment & Approbation

Operating Ambient Temperature Range	0 °C to 55 °C
Operating Humidity	0 – 95% non condensing
Storage Temperature	-25 °C to 85 °C
Storage Humidity	0-95% non condensing
Max Case Temperature (Tcase)	55 °C
Agency Approbations	CE, ENEC, RTTE, EMC
Warranty	5 years warranty for released Philips system combination (sensor and compatible driver). 3 years warranty for sensor only.

Digital Interface

	Xitanium SR
--	-------------

Other

Status Indicators	Red, Yellow. Yellow LED on: Vacancy & Sensor is functional; Red LED on: Motion is detected
Energy reporting	Calculated from last "power on": % On, Energy Consumed (Whr), System on time (hrs), Avg power consumed (w-hr), Lamp on time (hrs)
No. Drivers per Sensor	4 max
Max Distance Switch-to-First-Luminaire	10 m line-of-sight
Max Distance Luminaire-to-Luminaire	12 m line-of-sight
No. Switches per Group	10 max
Field Configuration	via NFC or IR, parameters set via Philips field apps

Operation and Configuration via Mobile App

EasyAir operates immediately upon installation and energization without further commissioning. If changes from default settings are desired, EasyAir can be configured via an app through NFC or IR embedded within the sensor.

Compliance to Radio Equipment Directive (RED)

The Directive ensures a single market for Radio and Telecommunication Terminal Equipment by setting harmonized standards for safety and health, electromagnetic compatibility and the efficient use of the radio spectrum. This applies to all products using the radio frequency spectrum. This device is compliant to the underlying harmonized standards which is verified by an independent Notified Body. Any changes or modifications not expressly approved by Philips could void the user's authority to operate this equipment. This product is intended for commercial use only.

