



Digital ignitors for maximum reliability

HID ignitors for series systems

HID ignitors for series systems

Benefits

- Easy installation and wiring
- Can operate with both semi-parallel and series ballasts
- Digital ignitors ensure maximum reliability

Features

- Ignitors equipped with screw terminal blocks as standard
- Series ignitor will only work in series circuits

Application

- Outdoor lighting (most popular application: road and tunnel lighting)

System

- Electromagnetic system requires ballast, ignitor and capacitor
- Designed to work only in series circuits
- No ignitor needed for SON-I lamps

PHILIPS

Related products



SI 51 & 51-S

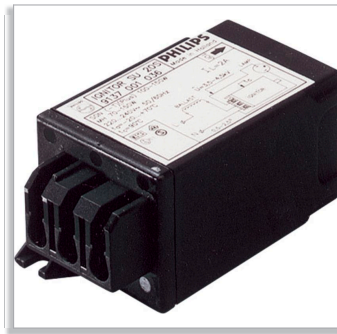

SI 54



SI 52



SN 59



SN 50, 56, 57, 57-S, 58 & 58-S



SND 57, 57-S, 58, 58-S, 88, 89, 90 & 91



SND 57, 57-S, 58, 58-S, 88, 89, 90 & 91

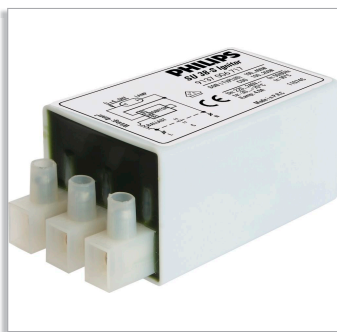
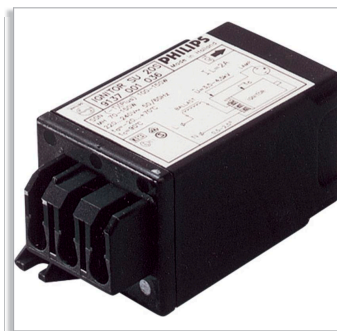

SU 38-S



SUD 10-S & 40-S

Related products



SX 26, 70, 72, 73, 74, 76 & 131

Dimensional drawing

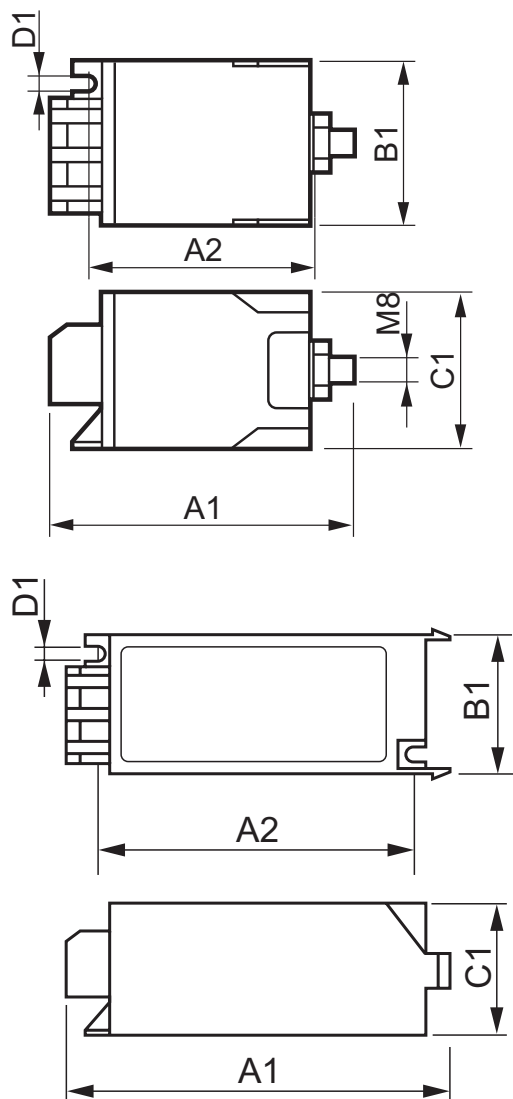

SI 51-S 220-240V 50/60Hz

Product	A1 (Norm)	A2 (Norm)	B1 (Norm)	C1 (Norm)	D1 (Norm)
SI 51-S 220-240V 50/60Hz	89.0	70.0	41.0	38.0	4.3

SI 54 380-415V 50/60Hz

Product	A1 (Norm)	A2 (Norm)	B1 (Norm)	C1 (Norm)	D1 (Norm)
SI 54 380-415V 50/60Hz	114.5	95.0	41.0	38.0	4.3

Dimensional drawing

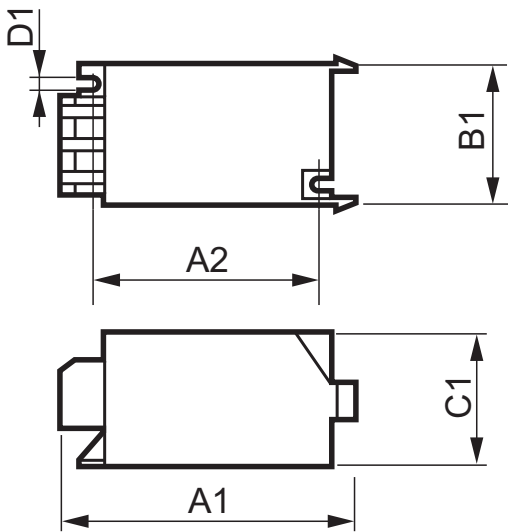

SI 51 220-240V 50/60Hz

Product	A1 (Norm)	A2 (Norm)	B1 (Norm)	C1 (Norm)	D1 (Norm)
SI 51 220-240V 50/60Hz	84.5	65.0	41.0	38.0	4.3
SI 52 220-240V 50/60Hz	84.5	65.0	41.0	38.0	4.3

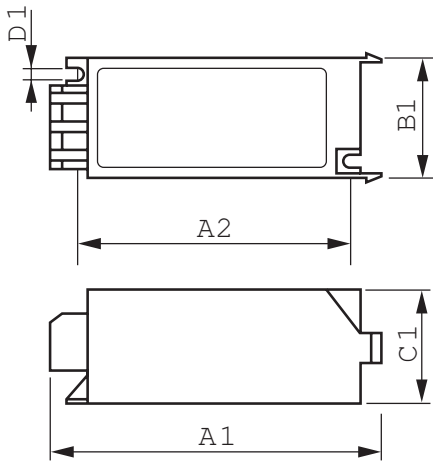

SN 61 220-240V 50/60Hz

Product	A1 (Norm)	A2 (Norm)	B1 (Norm)	C1 (Norm)	D1 (Norm)
SN 61 220-240V 50/60Hz	114.5	95.0	41.0	38.0	4.3

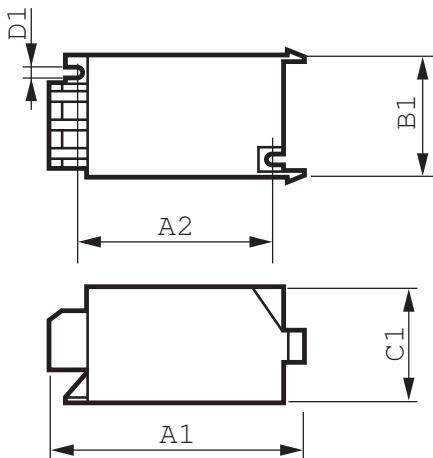

SN 58 220-240V 50/60Hz

Product	A1 (Norm)	A2 (Norm)	B1 (Norm)	C1 (Norm)	D1 (Norm)
SN 58 220-240V 50/60Hz	84.5	65.0	41.0	38.0	4.3

Dimensional drawing

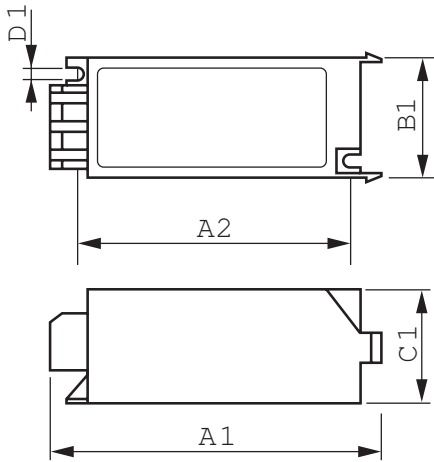

SN 59 220-240V 50/60Hz

Product	A1 (Norm)	A2 (Norm)	B1 (Norm)	C1 (Norm)	D1 (Norm)
SN 59 220-240V 50/60Hz	114.5	95.0	41.0	38.0	4.3
SN 56 220-240V 50/60Hz	114.5	95.0	41.0	38.0	4.3

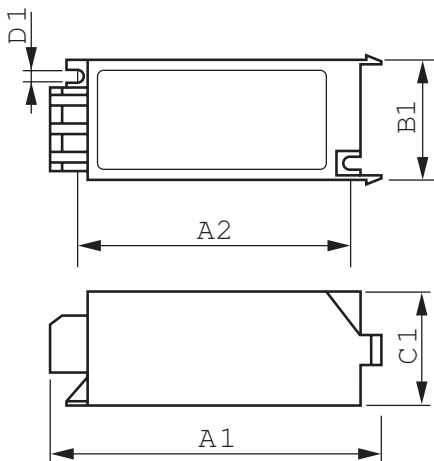

SX 76 220-240V 50/60Hz

Product	A1 (Norm)	A2 (Norm)	B1 (Norm)	C1 (Norm)	D1 (Norm)
SX 76 220-240V 50/60Hz	114.5	95.0	41.0	38.0	4.3
SX 70 220-240V 50/60Hz	114.5	95.0	41.0	38.0	4.3
SX 72 220-240V 50/60Hz	114.5	95.0	41.0	38.0	4.3
SX 74 220-240V 50/60Hz	114.5	95.0	41.0	38.0	4.3
SX 26 220-240V 50/60Hz	114.5	95.0	41.0	38.0	4.3

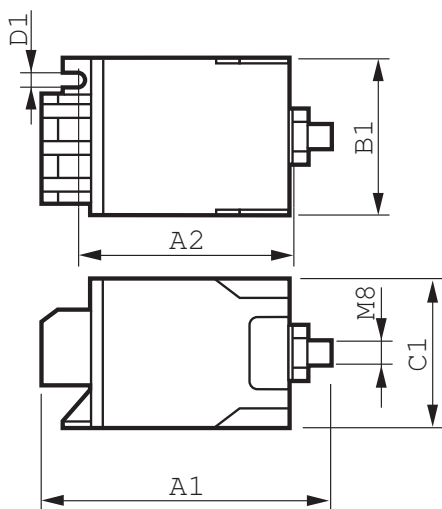

SN 58-S 220-240V 50/60Hz

Product	A1 (Norm)	A2 (Norm)	B1 (Norm)	C1 (Norm)	D1 (Norm)
SN 58-S 220-240V 50/60Hz	89.0	70.0	41.0	38.0	4.3

Dimensional drawing

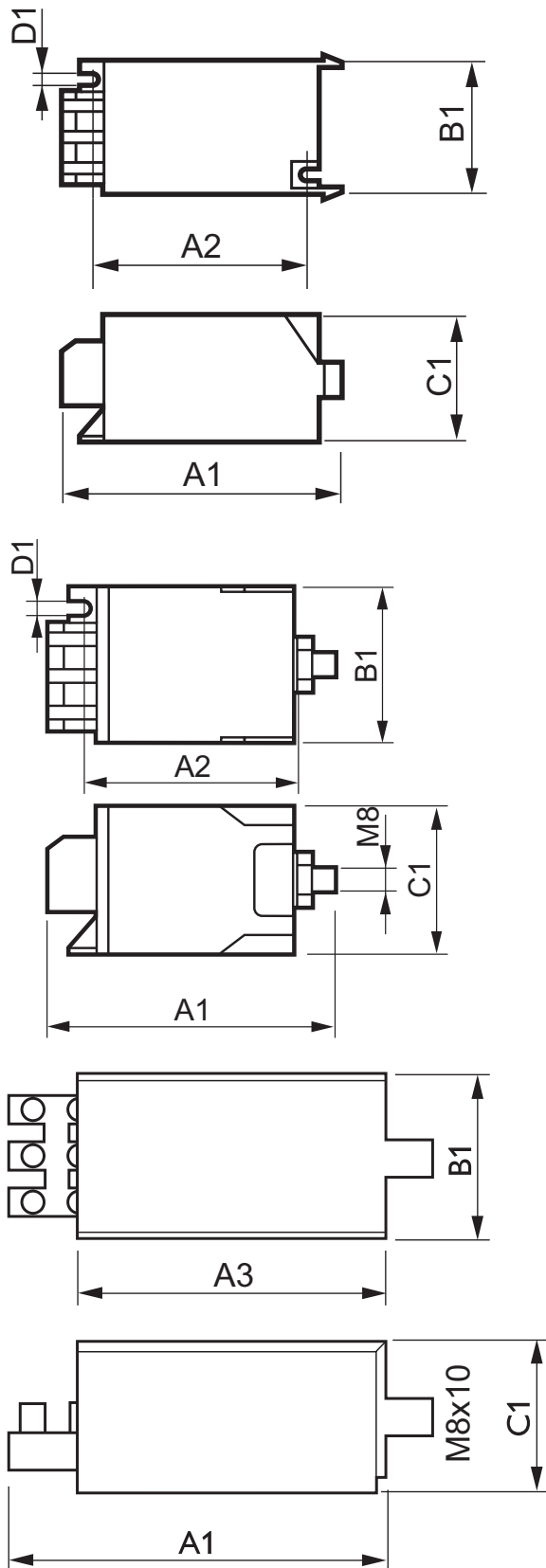

SND 57 220-240V 50/60Hz

Product	A1 (Norm)	A2 (Norm)	B1 (Norm)	C1 (Norm)	D1 (Norm)
SND 57 220-240V 50/60Hz	84.5	65.0	41.5	38.5	4.3
SND 58 220-240V 50/60Hz	84.5	65.0	41.5	38.5	4.3

SND 58-S 220-240V 50/60Hz

Product	A1 (Norm)	A2 (Norm)	B1 (Norm)	C1 (Norm)	D1 (Norm)
SND 58-S 220-240V 50/60Hz	89.0	70.0	41.5	38.5	4.3

SUD 10-S 220-240V 50/60Hz

Product	A1 (Norm)	A3 (Norm)	B1 (Norm)	C1 (Norm)
SUD 10-S 220-240V 50/60Hz	78	62	36	32

Dimensional drawing

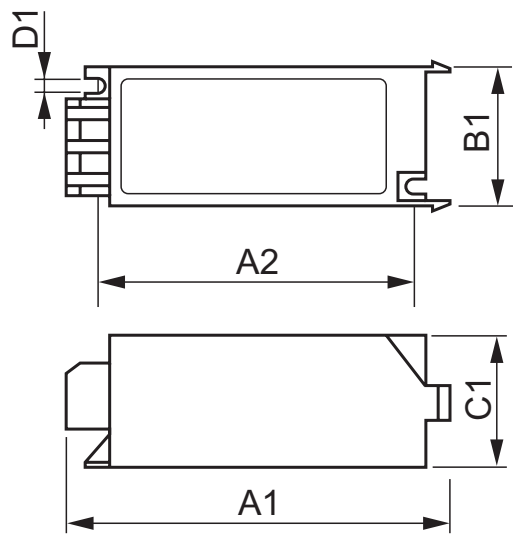

SND 90 480V 60Hz

Product	A1 (Norm)	A2 (Norm)	B1 (Norm)	C1 (Norm)	D1 (Norm)
SND 90 480V 60Hz	114.5	95.0	41.5	38.5	4.3
SND 88 400V 50/60Hz	114.5	95.0	41.5	38.5	4.3

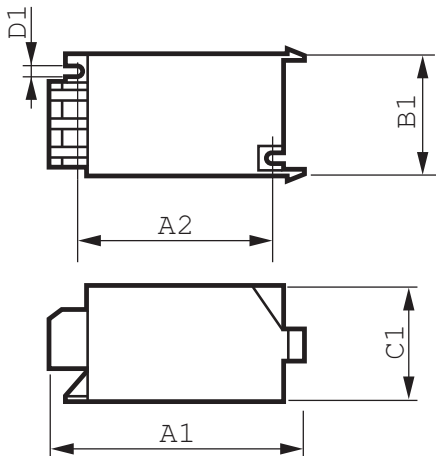

SX 131 220-240V 50/60Hz

Product	A1 (Norm)	A2 (Norm)	B1 (Norm)	C1 (Norm)	D1 (Norm)
SX 131 220-240V 50/60Hz	85.5	-	41.5	38.5	-
SX 73 220-240V 50/60Hz	85.5	-	41.5	38.5	-

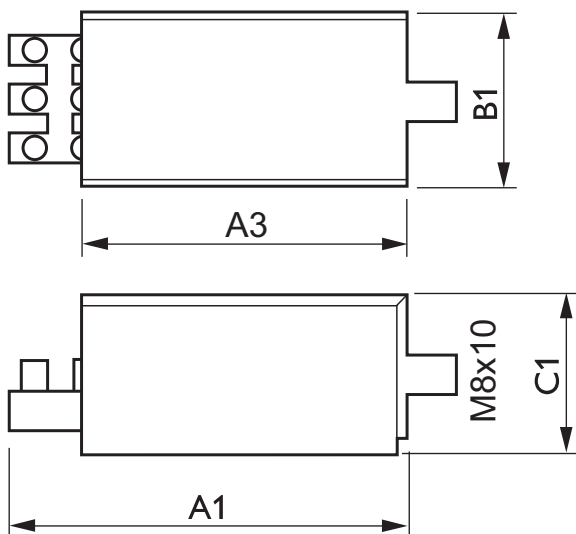

SU 38-S 220-240V 50/60Hz

Product	A1 (Norm)	A3 (Norm)	B1 (Norm)	C1 (Norm)
SU 38-S 220-240V 50/60Hz	78.0	62.0	36.0	32.0

General Characteristics

Order code	Full product name	Application code	Rated Lamp-type	Rated Number of Lamps	Rated Ballast-Lamp Power	Line Voltage	Line Frequency	Housing
913619519966	SI 51 220-240V 50/60Hz	51	HPI	1 piece	250/400	220-240 V	50/60 Hz	SNI-85
913700143666	SI 51-S 220-240V 50/60Hz	51-S	HPI	1 piece	250/400	220-240 V	50/60 Hz	STUD-89
913619149966	SI 54 380-415V 50/60Hz	54	HPI	1 piece	2000	380-415 V	50/60 Hz	SNI-115
913619529966	SI 52 220-240V 50/60Hz	52	HPI	1 piece	1000	220-240 V	50/60 Hz	SNI-85
913619659966	SN 59 220-240V 50/60Hz	59	SON/MHN	1 piece	1000/1800	220-240 V	50/60 Hz	SNI-115
913619579966	SN 58 220-240V 50/60Hz	58	SON/CDM/MH/HPI	1 piece	35-400	220-240 V	50/60 Hz	SNI-85
913619669966	SN 56 220-240V 50/60Hz	56	SON/MHN	1 piece	1800	220-240 V	50/60 Hz	SNI-115
913700124866	SN 58-S 220-240V 50/60Hz	58-S	SON-T	1 piece	50/70	220-240 V	50/60 Hz	STUD-89
913700615067	SND 88 400V 50/60Hz	88	GP-SON	1 piece	600	400 V	50/60 Hz	SNI-115
913700184966	SND 57 220-240V 50/60Hz	57	SON	1 piece	50/70	220-240 V	50/60 Hz	SNI-85
913700185166	SND 58 220-240V 50/60Hz	58	SON/CDM/MH/HPI/HPA	1 piece	35-600	220-240 V	50/60 Hz	SNI-85
913700185266	SND 58-S 220-240V 50/60Hz	58-S	SON/CDM/MH/HPI/HPA	1 piece	35-600	220-240 V	50/60 Hz	STUD-89
913700195967	SND 90 480V 60Hz	90	GP-SON	1 piece	600	480 V	60 Hz	SNI-115
913619569966	SN 61 220-240V 50/60Hz	61	SON/MH	1 piece	1000/1800	220-240 V	50/60 Hz	SNI-115
913700671791	SU 38-S 220-240V 50/60Hz	38-S	SON/CDO	1 piece	100-400	220-240 V	50/60 Hz	STUD-86
913700195891	SUD 10-S 220-240V 50/60Hz	10-S	SON/CDO	1 piece	50/70	220-240 V	50/60 Hz	-
913650050566	SX 76 220-240V 50/60Hz	76	SOX	1 piece	66/90	220-240 V	50/60 Hz	SNI-115
913654039066	SX 70 220-240V 50/60Hz	70	SOX/SOX-E	1 piece	90	220-240 V	50/60 Hz	SNI-115
913654059066	SX 72 220-240V 50/60Hz	72	SOX/SOX-E	1 piece	35/55	220-240 V	50/60 Hz	SNI-115
913654079066	SX 74 220-240V 50/60Hz	74	SOX/SOX-E	1 piece	91/135	220-240 V	50/60 Hz	SNI-115
913654109966	SX 26 220-240V 50/60Hz	26	SOX/SOX-E	1 piece	26/35	220-240 V	50/60 Hz	SNI-115
913700625366	SX 131 220-240V 50/60Hz	131	SOX-E	1 piece	131	220-240 V	50/60 Hz	SNI-85
913700625466	SX 73 220-240V 50/60Hz	73	SOX	1 piece	180	220-240 V	50/60 Hz	SNI-85

Wiring data

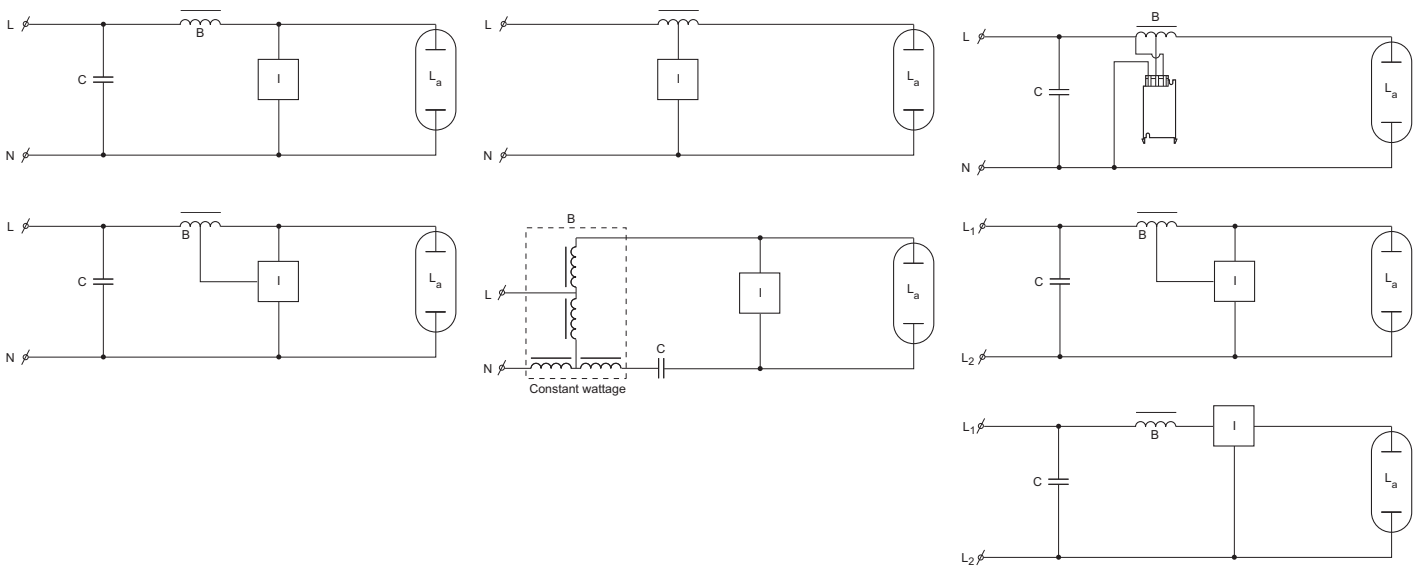



© 2015 Koninklijke Philips N.V. (Royal Philips)
All rights reserved.

Specifications are subject to change without notice. Trademarks are the property of Koninklijke Philips N.V. (Royal Philips) or their respective owners.

www.philips.com/lighting

2015, November 7
data subject to change