

PHILIPS

Ordering 12NC	929002803306
Brand Name	CertaDrive
Description	LED Driver12W 0.265A (Triac Dimmable)
Input Voltage	220 - 240V
Input Frequency	50 Hz
RoHS	Yes
Approbations	IS 15885 (Part 2 / Sec 13)
Status	BIS Certified

Output Power (W)	Output Voltage (V)	Output Current (ADC)	Efficiency at Max Load	Max Case Temp (°C)	Input Current (Arms)	Max Input Power (W)	Inrush Current (Apk/50%-µs)	THD @ Max Load (%)	Power Factor @Max Load	Surge Protection Diff(KV)	Weight (Kg)	Envir. Protection Rating
10	23-37.5	0.265	240V	65	240V	12	240V	≤ 20 @Max Load	≥ 0.90	2.5	0.075	IP20
		±10%	≥80		0.055		7/300	Load				

Wire Diagram

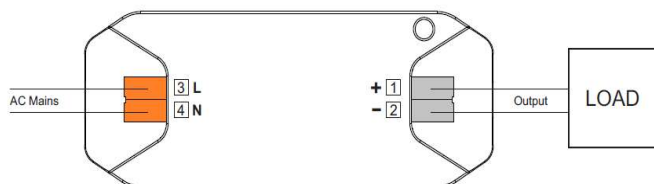

X1	Signal	Description	Notes
Pin3	L	Line	Orange
Pin4	N	Neutral	Orange

X2 Connector	Signal	Description	Notes
Pin1	+	LED output positive	Grey
Pin2	-	LED output negative	Grey

Connector type: 250
 Wire Type: Solid wire 0.75...1.5 mm2
 Wire strip length: 8...9mm

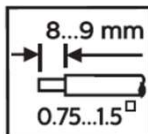

Enclosure

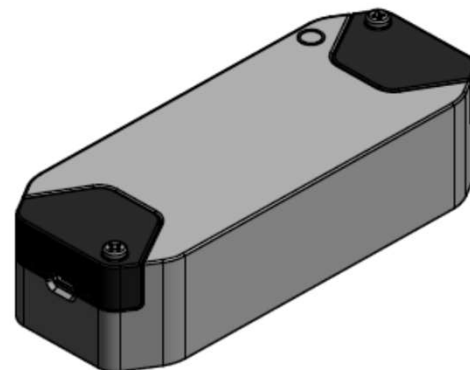

	(mm)
Case Length	115
Case Width	45
Case Height	29
Mounting Length	105
Mounting Width	23.4

PHILIPS

Ordering 12NC	929002803306
Brand Name	CertaDrive
Description	LED Driver12W 0.265A (Triac Dimmable)
Input Voltage	220 - 240V
Input Frequency	50 Hz
RoHS	Yes
Approbations	IS 15885 (Part 2 / Sec 13)
Status	BIS Certified

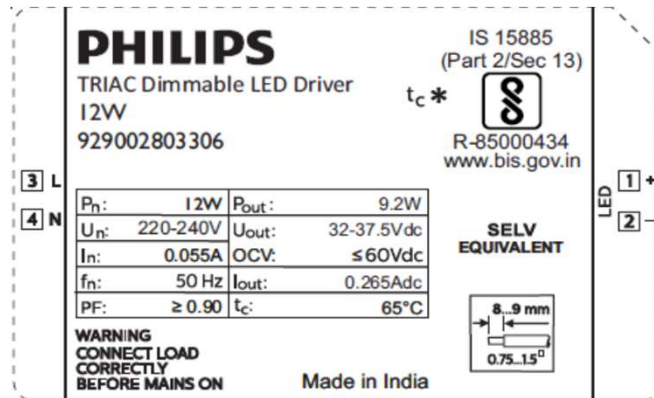

Product Data	
Full product code	929002803306
Full product name	LED Driver12W 0.265A (Triac Dimmable)
Net weight per piece	0.075
Dimming	Yes (Triac dimmable, phase cut)
Dimming Range	min. 20% to max.100% (triac dependent)
Ambient Temp. Range	-10°C to 45°C
Line Voltage (AC Nominal)	220 - 240V +/-10%
Line Voltage	120 - 270V
Line Current	0.055A @ 240V
Line Frequency	50 Hz
Envir. Protection Rating	IP20
Life at T_c 65 degree C	30000 hrs (nom.)
T_c - Max. (°C)	65
Inrush Current	7/300 (Apk/50%-µs)
Max. Driver number on MCB 16A (Type B)	31 (max.)
Input Over Voltage	Can Survive input Voltage Stress of 320V for 48 hours
Input Over Voltage Cut Off	NA
Input Over Voltage Protection	Can Survive input Voltage Stress of 350V for 2 hours
Input Under Voltage Protection	Can Survive input Voltage Stress of 100V for 48 hours
LED Current Tolerance	$\pm 10\%$
Output Current Ripple	$\leq 30\%$ (ripple = pk / avg.) for frequency 50 - 1K Hz
THD Total	$\leq 20\%$ @ Full Load @ 240V Supply
P.F. at Max. Load	≥ 0.90
Isolation (Input - Output)	Basic insulation 2.75KV
Protection	Short Circuit and Open Circuit Protection for LED + and LED -
Standby Power	$\leq 0.5W$



Ordering 12NC	929002803306
Brand Name	CertaDrive
Description	LED Driver12W 0.265A (Triac Dimmable)
Input Voltage	220 - 240V
Input Frequency	50 Hz
RoHS	Yes
Approbations	IS 15885 (Part 2 / Sec 13)
Status	BIS Certified

Installation & Application Notes :

Section I - Physical Characteristics

- 1.1 LED Driver shall be installed inside an electrical enclosure
- 1.2 Wiring inside electrical enclosure shall comply with 600V/105°C rating or higher

Section II - Performance

- 2.1 LED Driver has a rated lifetime of 30,000 hours @ $T_c \leq 65^\circ\text{C}$
- 2.2 LED Driver tolerates sustained open circuit and short circuit output conditions without damage
- 2.3 LED Driver maximum allowable case temperature is 65°C - see product label for measurement location
- 2.4 LED Driver complies with the requirements of IS 15885 (Part 2 / Sec 13)

ELECTRICAL RATINGS :

Model	Input, 50/60 Hz		Output (nominal)		
	V	A	V DC	A DC	Watts
LED Driver12W 0.265A (Triac Dimmable)	220 - 240	0.055	23-37.5	0.265	10

TECHNICAL CONSIDERATIONS (NOT FOR FIELD REPRESENTATIVES USE) :

Section III - Conditions of acceptability

When installed in the end-use equipment, the following are among the considerations to be made :

- 3.1 The equipment shall be installed in compliance with the enclosure, mounting, spacing, casualty and segregation requirements of the ultimate application.
- 3.2 The driver is suitable for use in "indoor use only" locations.
- 3.3 When the drivers are installed in the end-use application, the case temperature should not exceed the temperature limits specified in the following table:

Model	Input Voltage, Hz	Max Case @ T_C , $^\circ\text{C}$
LED Driver12W 0.265A (Triac Dimmable)	220 - 240 , 50	65