

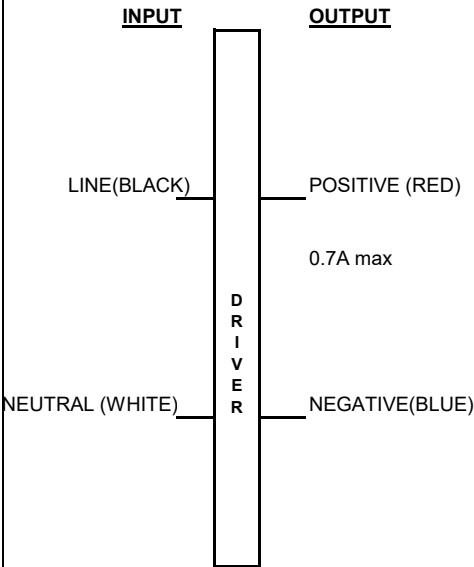

Ordering 12 NC	9290 033 99206
Brand Name	LED Driver
Description	Certa Drive 50W 0.7A
Model Number	C050C070V064FNM4AO
Input Voltage	220 - 240V
Input Frequency	50 Hz
RoHS	Yes
Approbations	IS 15885 (Part 2 / Sec 13)
Status	BIS Approved

Input Power	Input Current	Power Factor	THD @ Max Load	Surge Protection	Output Power	Output Voltage	Output Current	Efficiency at Max Load	Max Case Temp	Weight	Envir. Protection
(W)	(Arms)	@Max Load	(%)	Diff.(KV)	(W)	(VDC)	(A)	(%)	(°C)	(Kg)	Rating
50	240V	0.95	<10 Load	4	45	40-66	0.7	240V	80	0.163	Dry and Damp
	0.210							>85			

Wiring Diagram



Input Terminal
Wire type: 2 wire.

Output Terminal
Wire type: 2 wire.

Enclosure

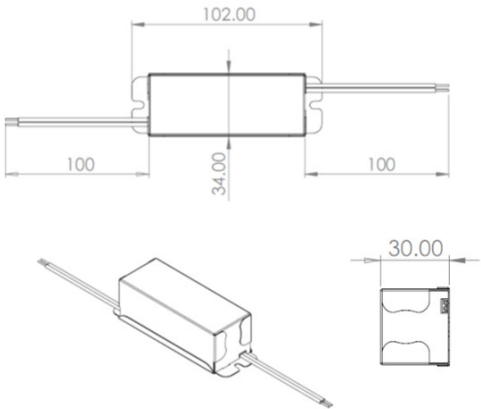

	(mm)
Case Length	102
Case Width	34
Case Height	30
Mounting Length	85
Wire length	100

PHILIPS

Ordering 12 NC	9290 033 99206
Brand Name	LED Driver
Description	Certa Drive 50W 0.7A
Model Number	C050C070V064FNM4AO
Input Voltage	220 - 240V
Input Frequency	50 Hz
RoHS	Yes
Approbations	IS 15885 (Part 2 / Sec 13)
Status	BIS Approved



CertaDrive
50W 0.7A 66V
Model No : C050C070V064FNM4AO

U_n : 240V, 50Hz	U_{out} : 40-66Vdc
I_n : 0.210A	I_{out} : 0.7Adc
P_n : 50W	P_{out} : 45W
PF : ≥ 0.95	THD : $\leq 10\%$

CASE GND U_{out} max. (OCV): $\leq 100Vdc$ max.

IS 15885
(Part 2/Sec 13)



R-85000434
www.bis.gov.in

80°C max.
Tc

Surge: 4KV DM/CM
Cut off : $>325V$, $<100V$
OTP : $T_c > 90^\circ C$

Dry & Damp location Made in India



RED +
LED
BLUE -

Product Data	
Full product code	9290 033 99206
Full product name	Certa Drive 50W 0.7A
Net weight per piece	0.163 gms
Dimming	None (FIXED)
Ambient Temp. Range	-10C to +55C
AC Input Voltage (Performance range)	Typical 240V (Min- 198V , Max - 254V)
AC Input Voltage (Operating range)	Typical 240V (Min- 100V , Max - 320V)
Line Current	0.21A
Line Frequency	50 Hz
Envir. Protection Rating	Dry and damp
Life at Tc 80 degree C	30000 hrs (nom.)
Suitable For Outdoor Use	Yes
Tc - Max.	80°C
Max. Driver number on MCB 16A (Type B)	60 (max.)
Input Over Voltage	Can Survive input Voltage Stress of 320V for 48 hours Can Survive input Voltage Stress of 360V for 12 hours Can Survive input Voltage Stress of 440V for 8 hours
Input Under Voltage Protection	Can Survive input Voltage Stress of 100V for 48 hours
Input Over Voltage Cut Off	Auto Shutdown at $\geq 325V$ and Auto Recovery at 300V - 315V
Input under voltage shutdown	Auto Shutdown at $\leq 95V$ and auto Recovery at 95 - 100V
EMI (CISPR15)	No
Output Current Tolerance	+/- 5% of I_{max}
THD Total	$\leq 10\%$ @ Full Load @ 240V Supply
P.F. at Max. Load	≥ 0.95
Isolation (Input - Output)	Basic Isolation
Protection	Short Circuit and Open Circuit Protection for LED + and LED -



Ordering 12 NC	9290 033 99206
Brand Name	LED Driver
Description	Certa Drive 50W 0.7A
Model Number	C050C070V064FNM4AO
Input Voltage	220 - 240V
Input Frequency	50 Hz
RoHS	Yes
Approbations	IS 15885 (Part 2 / Sec 13)
Status	BIS Approved

Installation & Application Notes :

Section I - Physical Characteristics

- 1.1 LED Driver shall be installed inside / outside an electrical enclosure.
- 1.2 Wiring inside electrical enclosure shall comply with 600V/105°C rating or higher

Section II - Performance

- 2.1 LED Driver has a rated lifetime of 30,000 hours @ $T_c \leq 80^\circ\text{C}$
- 2.2 LED Driver tolerates sustained open circuit and short circuit output conditions without damage
- 2.3 LED Driver maximum allowable case temperature is 80°C - see product label for measurement location
- 2.4 LED Driver complies with the requirements of IS 15885 (Part 2 / Sec 13)

ELECTRICAL RATINGS :

Model	Input, 50 Hz		Output (nominal)		
	V	A	V DC	A DC	Watts
Certa Drive 50W 0.7A	220 - 240	0.21	66	0.7	50

TECHNICAL CONSIDERATIONS (NOT FOR FIELD REPRESENTATIVES USE) :

Section III - Conditions of acceptability

When installed in the end-use equipment, the following are among the considerations to be made :

- 3.1 The equipment shall be installed in compliance with the enclosure, mounting, spacing, casualty and segregation requirements of the ultimate application.
- 3.2 The driver is suitable for indoor LED Lighting application.
- 3.3 The driver is suitable for use in Dry & Damp locations.
- 3.4 When the drivers are installed in the end-use application, the case temperature should not exceed the temperature limits specified in the following table:

Model	Input Voltage, Hz	Max Case @ TC , °C
Certa Drive 50W 0.7A	220 - 240 , 50	80



©2021 Signify Holding, IBRS 10461, 5600 VB, NL. All rights reserved.

Address: Signify Innovations India Ltd
9B, DLF 9th Floor
DLF Cyber City, DLF Phase III
Gurgaon 122002
India

The information provided herein is subject to change without notice. Signify does not give any representation or warranty as to the accuracy or completeness of the information included herein and shall not be liable for any action in reliance thereon. The information presented in this document is not intended as any commercial offer and does not form part of any quotation or contract, unless otherwise agreed by Signify.

Philips and the Philips Shield Emblem are registered trademarks of Koninklijke Philips N.V. All other trademarks are owned by Signify Holding or their respective owners. Date of release: May 15, 2022