

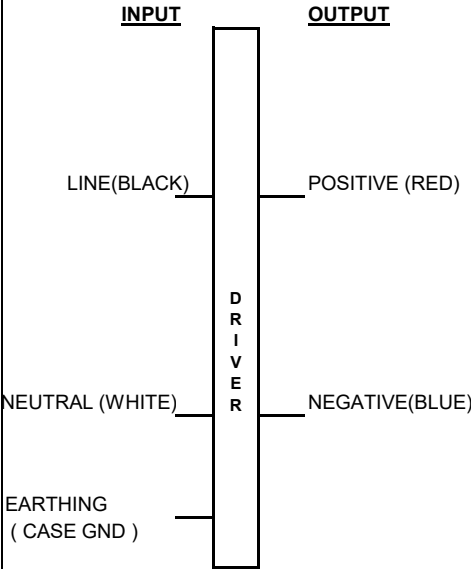

Ordering 12 NC	9290 034 23606
Brand Name	LED Driver
Description	CertaDrive 40W 1.0A 40V
Model Number	C040C100V040FNM4AOC1
Input Voltage	220 - 240V
Input Frequency	50 Hz
RoHS	Yes
Approbations	IS 15885 (Part 2 / Sec 13)
Status	BIS under Progress

Input Power	Input Current	Power Factor	THD @ Max Load	Surge Protection	Output Power	Output Voltage	Output Current	Efficiency at Max Load	Max Case Temp	Weight	Envir. Protection
(W)	(Arms)	@Max Load	(%)	Diff.(KV)	(W)	(VDC)	(A)	(%)	(°C)	(Kg)	Rating
45	240V	0.95	<10 Load	4	40	30-40	1.0	240V	80	0.170	Dry and Damp
	0.23							>85			

Wiring Diagram



Input Terminal
Wire type: 2 wire.

Output Terminal
Wire type: 2 wire.

Enclosure

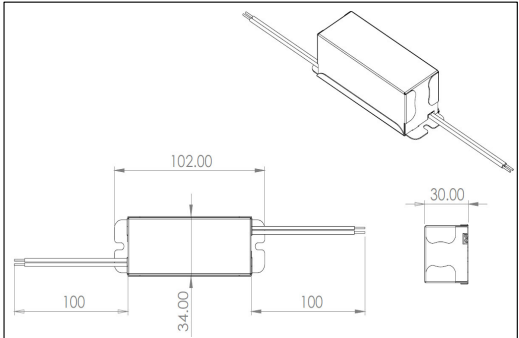
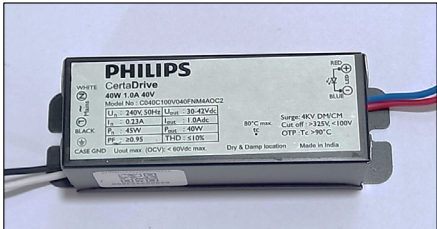

	(mm)
Case Length	102
Case Width	34
Case Height	30

PHILIPS

Ordering 12 NC	9290 034 23606
Brand Name	LED Driver
Description	CertaDrive 40W 1.0A 40V
Model Number	C040C100V040FNM4AOC1
Input Voltage	220 - 240V
Input Frequency	50 Hz
RoHS	Yes
Approbations	IS 15885 (Part 2 / Sec 13)
Status	BIS under Progress

PHILIPS
CertaDrive
40W 1.0A 40V
Model No : C040C100V040FNM4AOC1

U_n : 240Vac, 50Hz	U_{out} : 30-42Vdc
I_n : 0.23Aac	I_{out} : 1.0Adc
P_n : 45W	P_{out} : 40W
PF : ≥ 0.95	THD : $\leq 10\%$

CASE GND U_{out} max. (OCV): <60Vdc max. Dry & Damp location Made in India

IS 15885
(Part 2/Sec 13)

R-72006327
www.bis.gov.in

80°C max.
tc

Surge: 4KV DM/CM
Cut off : >325V, <100V
OTP : Tc >85°C

Product Data	
Full product code	9290 034 23606
Full product name	CertaDrive 40W 1.0A 40V
Net weight per piece	0.17 gms
Dimming	None (FIXED)
Ambient Temp. Range	-10C to +50C
AC Input Voltage (Performance range)	Typical 230V (Min- 220V , Max - 240V)
AC Input Voltage (Operating range)	Typical 240V (Min- 110V , Max - 300V)
Line Current	0.23A
Line Frequency	50 Hz
Envir. Protection Rating	Dry and damp
Life at Tc 80 degree C	30000 hrs (nom.)
Suitable For Outdoor Use	Yes
Tc - Max.	80°C
Max. Driver number on MCB 16A (Type B)	31 (max.)
Input Over Voltage	Can Survive input Voltage Stress of 320V for 48 hours Can Survive input Voltage Stress of 360V for 12 hours Can Survive input Voltage Stress of 440V for 8 hours
Input Under Voltage Protection	Can Survive input Voltage Stress of 100V for 48 hours
Input Over Voltage Cut Off	Auto Shutdown at $\geq 325V$ and Auto Recovery at 300V - 315V
Input under voltage shutdown	Auto Shutdown at $\leq 95V$ and auto Recovery at 95 - 100V
Output Current Tolerance	+/- 5% of I_{max}
Output Ripple Current	$\leq 35\%$ (ripple = pk / avg.)
THD Total	$\leq 10\%$ @ Full Load @ 240V Supply
P.F. at Max. Load	≥ 0.95
Isolation (Input - Output)	Basic Isolation
Protection	Short Circuit and Open Circuit Protection for LED + and LED -



Ordering 12 NC	9290 034 23606
Brand Name	LED Driver
Description	CertaDrive 40W 1.0A 40V
Model Number	C040C100V040FNM4AOC1
Input Voltage	220 - 240V
Input Frequency	50 Hz
RoHS	Yes
Approbations	IS 15885 (Part 2 / Sec 13)
Status	BIS under Progress

Installation & Application Notes :

Section I - Physical Characteristics

- 1.1 LED Driver shall be installed inside / outside an electrical enclosure.
- 1.2 Wiring inside electrical enclosure shall comply with 1100V/105 °C rating or higher

Section II - Performance

- 2.1 LED Driver has a rated lifetime of 30,000 hours @ $T_c \leq 80^\circ\text{C}$
- 2.2 LED Driver tolerates sustained open circuit and short circuit output conditions without damage
- 2.3 LED Driver maximum allowable case temperature is 80°C - see product label for measurement location
- 2.4 LED Driver complies with the requirements of IS 15885 (Part 2 / Sec 13)

ELECTRICAL RATINGS :

Model	Input, 50 Hz		Output (nominal)		
	V	A	V DC	A DC	Watts
CeraDrive 40W 1.0A 40V	220 - 240	0.23	40	1.0	40

TECHNICAL CONSIDERATIONS (NOT FOR FIELD REPRESENTATIVES USE) :

Section III - Conditions of acceptability

When installed in the end-use equipment, the following are among the considerations to be made :

- 3.1 The equipment shall be installed in compliance with the enclosure, mounting, spacing, casualty and segregation requirements of the ultimate application.
- 3.2 The driver is suitable for indoor LED Lighting application.
- 3.3 The driver is suitable for use in Dry & Damp locations.
- 3.4 When the drivers are installed in the end-use application, the case temperature should not exceed the temperature limits specified in the following table:

Model	Input Voltage, Hz	Max Case @ TC , °C
CeraDrive 40W 1.0A 40V	220 - 240 , 50	80



©2021 Signify Holding, IBRS 10461, 5600 VB, NL. All rights reserved.

Address: Signify Innovations India Ltd
9B, DLF 9th Floor
DLF Cyber City, DLF Phase III
Gurgaon 122002
India

The information provided herein is subject to change without notice. Signify does not give any representation or warranty as to the accuracy or completeness of the information included herein and shall not be liable for any action in reliance thereon. The information presented in this document is not intended as any commercial offer and does not form part of any quotation or contract, unless otherwise agreed by Signify.

Philips and the Philips Shield Emblem are registered trademarks of Koninklijke Philips N.V. All other trademarks are owned by Signify Holding or their respective owners. Date of release: Sept 05, 2022